



LED STRIPLIGHT FIXTURE

LSF8 series

► **DESIGN** - LED STRIPLIGHT FIXTURE has a narrow, low-profile design. Durable commercial grade housing resistant to rust and impact along with an anti-glare PMMA lens provide many years of use. It is designed to operate on 120-277V or 200-480V circuits with a 0-10V dimmable driver.

► **VARIETY** - The fixtures come in 2ft, 4ft and 8ft sizes. White and black finish options.

► **COLOR AND POWER SELECTABLE** - You can choose either a 3500K neutral white, 4000K cool white or 5000K daylight color temperature (depending on the model), and change the power with a simple switch.

► **APPLICATION** - Perfect commercial or industrial solution for office buildings, schools, hospitals, hallways, stairwells, workshops, and many other applications. It is also Damp Locations rated.

► **ADVANTAGES** - With calculated lifespan up to 174 000 hours, these fixtures are made to last decades under normal operation! ASD provides a 5-year limited warranty along with UL and DLC Standard certifications to guarantee top quality products and safety!

► OPTIONS:

MODELS WITH MOTION SENSOR BASE - The fixture has a built-in motion sensor base, allowing you to install the microwave motion sensor, which will turn off the fixture automatically when no motion is detected (sold separately).

MODELS WITH BATTERY BACK-UP - The built-in battery back-up provide 90 minutes of power in case of emergency.



Finish: ☐ White ☐ Black

PRODUCT PRESENTATION:

Model	Type	Power	Sensor base	Voltage	Dimming	Lumens	CCT	Finish	Dimensions	Pre-installed	Certification
LSF8											
ASD-LSF8-2A25WH	2 ft	15/20/25 W	-	120-277V	0-10V	3,377 lm	3,500/4,000/5,000 K	White	24" x 2-11/16" x 3-1/8"	-	UL (E473804), DLC Premium
ASD-LSF8-4A40WH	4 ft	20/30/40W	-	120-277V	0-10V	5,866 lm	3,500/4,000/5,000 K	White	47-1/4" x 2-11/16" x 3-1/8"	-	UL (E473804), DLC Premium
ASD-LSF8-4A40BK	4 ft	20/30/40W	-	120-277V	0-10V	5,866 lm	3,500/4,000/5,000 K	Black	47-1/4" x 2-11/16" x 3-1/8"	-	UL (E473804), DLC Premium
ASD-LSF8-4A70WH	4 ft	50/60/70 W	-	120-277V	0-10V	9,883 lm	3,500/4,000/5,000 K	White	47-1/4" x 2-11/16" x 3-1/16"	-	UL (E473804), DLC Premium
ASD-LSF8-8A80WH	8 ft	55/75/80 W	-	120-277V	0-10V	12,224 lm	3,500/4,000/5,000 K	White	94-1/2" x 2-11/16" x 3-1/8"	-	UL (E473804), DLC Standard
ASD-LSF8-8A80BK	8 ft	55/75/80 W	-	120-277V	0-10V	12,224 lm	3,500/4,000/5,000 K	Black	94-1/2" x 2-11/16" x 3-1/8"	-	UL (E473804), DLC Standard
ASD-LSF8-8A150WH	8 ft	100/130/150 W	-	120-277V	0-10V	21,427 lm	3,500/4,000/5,000 K	White	94-1/2" x 2-11/16" x 3-3/16"	-	UL (E473804), DLC Standard
LSF8 WITH Q-BASE											
ASD-LSF8-2A25WH-QB	2 ft	15/20/25 W	clip-in-base	120-277V	0-10V	3,378 lm	3,500/4,000/5,000 K	White	24" x 2-11/16" x 3-1/4"	-	UL (E473804), DLC Premium
ASD-LSF8-4A40WH-QB	4 ft	20/30/40 W	clip-in-base	120-277V	0-10V	5,522 lm	3,500/4,000/5,000 K	White	47-1/4" x 2-11/16" x 3-1/4"	-	UL (E473804), DLC Premium
ASD-LSF8-8A80WH-QB	8 ft	55/75/80 W	clip-in-base	120-277V	0-10V	11,782 lm	3,500/4,000/5,000 K	White	94-1/2" x 2-11/16" x 3-1/4"	-	UL (E473804), DLC Standard
LSF8 200-480V											
ASD-LSF8HV-4A40WH	4 ft	20/30/40 W	-	200-480V	0-10V	5,866 lm	3,500/4,000/5,000 K	White	47-1/4" x 2-11/16" x 3-3/16"	-	UL(E473804), DLC Premium
ASD-LSF8HV-8A80WH	8 ft	55/75/80 W	-	200-480V	0-10V	12,224 lm	3,500/4,000/5,000 K	White	94-1/2" x 2-11/16" x 3-3/16"	-	UL(E473804), DLC Premium
LSF8 WITH BATTERY BACK-UP											
ASD-LSF8-2A25WH-8EM	2 ft	15/20/25 W	-	120-277V	0-10V	3,377 lm	3,500/4,000/5,000 K	White	24" x 2-11/16" x 3-1/8"	8W Battery back-up	UL (E473804), DLC Premium
ASD-LSF8-4A40WH-10EM	4 ft	20/30/40 W	-	120-277V	0-10V	5,866 lm	3,500/4,000/5,000 K	White	47-1/4" x 2-11/16" x 3-1/8"	10W Battery back-up	UL (E473804), DLC Premium
ASD-LSF8-4A40BK-10EM	4 ft	20/30/40 W	-	120-277V	0-10V	5,866 lm	3,500/4,000/5,000 K	Black	47-1/4" x 2-11/16" x 3-1/8"	10W Battery back-up	UL (E473804), DLC Premium
ASD-LSF8-8A80WH-15EM	8 ft	55/75/80 W	-	120-277V	0-10V	12,224 lm	3,500/4,000/5,000 K	White	94-1/2" x 2-11/16" x 3-1/8"	15W Battery back-up	UL (E473804), DLC Standard
ASD-LSF8-8A80BK-15EM	8 ft	55/75/80 W	-	120-277V	0-10V	12,224 lm	3,500/4,000/5,000 K	Black	94-1/2" x 2-11/16" x 3-1/8"	15W Battery back-up	UL (E473804), DLC Standard
LSF8 WITH Q-BASE AND BATTERY BACK-UP											
ASD-LSF8-2A25WH-QB-8EM	2 ft	15/20/25 W	clip-in-base	120-277V	0-10V	3,378 lm	3,500/4,000/5,000 K	White	24" x 2-11/16" x 3-1/4"	8W Battery back-up	UL (E473804), DLC Premium
ASD-LSF8-4A40WH-QB-10EM	4 ft	20/30/40 W	clip-in-base	120-277V	0-10V	5,522 lm	3,500/4,000/5,000 K	White	47-1/4" x 2-11/16" x 3-1/4"	10W Battery back-up	UL (E473804), DLC Premium
ASD-LSF8-8A80WH-QB-15EM	8 ft	55/75/80 W	clip-in-base	120-277V	0-10V	11,782 lm	3,500/4,000/5,000 K	White	94-1/2" x 2-11/16" x 3-1/4"	15W Battery back-up	UL (E473804), DLC Standard
SENSORS AND REMOTE											
ASD-M22IR-VIH	Motion sensor with clip-in-base								1-7/8" x 1-3/16" x 1-3/16"	-	-
ASD-Q6RC	Remote control for motion sensor								5-11/16" x 1-3/4" x 13/16"	-	-

For detailed luminous flux information please refer to Annex 1, page 7.

For most up-to-date spec sheets please refer to asd-lighting.com

ASD LIGHTING CORP

E-mail: orders@asd-lighting.com | Web site: www.asd-lighting.com





LED STRIPLIGHT FIXTURE

LSF8 series

TECHNICAL PARAMETERS:

Model	Max input current	Inrush current	Work environment	Operating temperature	Power factor	Beam angle	Surge protection	Housing	Lens	CRI
LSF8										
ASD-LSF8-2A25WH	0.56A	50A	Damp location	-4°F to 122°F (-20°C to 50°C)	> 0.9	120°	2kV	Iron	PC	> 80
ASD-LSF8-4A40WH	0.56A	50A	Damp location	-4°F to 122°F (-20°C to 50°C)	> 0.9	90°	2kV	Iron	PC	> 80
ASD-LSF8-4A40BK	0.56A	50A	Damp location	-4°F to 122°F (-20°C to 50°C)	> 0.9	90°	2kV	Iron	PC	> 80
ASD-LSF8-4A70WH	1A	80A	Damp location	-4°F to 122°F (-20°C to 50°C)	> 0.9	120°	6kV	Iron	PC	> 80
ASD-LSF8-8A80WH	1A	80A	Damp location	-4°F to 122°F (-20°C to 50°C)	> 0.9	90°	6kV	Iron	PC	> 80
ASD-LSF8-8A80BK	1A	80A	Damp location	-4°F to 122°F (-20°C to 50°C)	> 0.9	90°	6kV	Iron	PC	> 80
ASD-LSF8-8A150WH	2A	80A	Damp location	-4°F to 122°F (-20°C to 50°C)	> 0.9	120°	6kV	Iron	PC	> 80
LSF8 WITH Q-BASE										
ASD-LSF8-2A25WH-QB	0.56A	50A	Damp location	-4°F to 122°F (-20°C to 50°C)	> 0.9	120°	2kV	Iron	PC	> 80
ASD-LSF8-4A40WH-QB	0.56A	50A	Damp location	-4°F to 122°F (-20°C to 50°C)	> 0.9	120°	2kV	Iron	PC	> 80
ASD-LSF8-8A80WH-QB	1A	80A	Damp location	-4°F to 122°F (-20°C to 50°C)	> 0.9	120°	6kV	Iron	PC	> 80
LSF8 200-480V										
ASD-LSF8HV-4A40WH	0.25A	120A	Damp location	-4°F to 122°F (-20°C to 50°C)	> 0.9	120°	6kV	Iron	PC	> 80
ASD-LSF8HV-8A80WH	0.5A	120A	Damp location	-4°F to 122°F (-20°C to 50°C)	> 0.9	120°	6kV	Iron	PC	> 80
LSF8 WITH BATTERY BACK-UP										
ASD-LSF8-2A25WH-8EM	0.56A	50A	Damp location	32°F to 122°F (0°C to 50°C)	> 0.9	120°	2kV	Iron	PC	> 80
ASD-LSF8-4A40WH-10EM	0.56A	50A	Damp location	32°F to 122°F (0°C to 50°C)	> 0.9	90°	2kV	Iron	PC	> 80
ASD-LSF8-4A40BK-10EM	0.56A	50A	Damp location	32°F to 122°F (0°C to 50°C)	> 0.9	90°	2kV	Iron	PC	> 80
ASD-LSF8-8A80WH-15EM	1A	80A	Damp location	32°F to 122°F (0°C to 50°C)	> 0.9	90°	6kV	Iron	PC	> 80
ASD-LSF8-8A80BK-15EM	1A	80A	Damp location	32°F to 122°F (0°C to 50°C)	> 0.9	90°	6kV	Iron	PC	> 80
LSF8 WITH Q-BASE AND BATTERY BACK-UP										
ASD-LSF8-2A25WH-QB-8EM	0.56A	50A	Damp location	32°F to 122°F (0°C to 50°C)	> 0.9	120°	2kV	Iron	PC	> 80
ASD-LSF8-4A40WH-QB-10EM	0.56A	50A	Damp location	32°F to 122°F (0°C to 50°C)	> 0.9	120°	2kV	Iron	PC	> 80
ASD-LSF8-8A80WH-QB-15EM	1A	80A	Damp location	32°F to 122°F (0°C to 50°C)	> 0.9	120°	6kV	Iron	PC	> 80

DIMMING COMPATIBLE CONTROLS:

Brand	Lutron	Eaton	
Models	DVSTV-453P	DF10P	SF10P

PACKAGE CONTENTS:

Description	Quantity
LED Striplight Fixture	1
V Hook (A)	1
J-box mounting plate (B)	1
Box	1

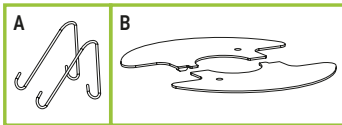

ACCESSORIES (sold separately):

Motion sensor with clip-in-base
ASD-M22IR-WH

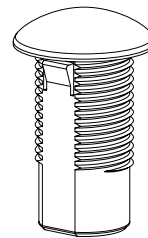

Remote control for motion sensor
ASD-06RC

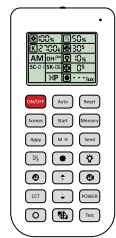

Connection bracket
ASD-CB-LSF8

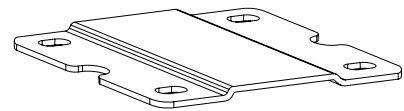

ACCESSORY COMPATIBILITY LIST:

Model	Accessories	Motion sensor with clip-in-base ASD-M22IR	Connection bracket ASD-CB-LSF8-WH ASD-CB-LSF8-BK
ASD-LSF8			•
ASD-LSF8-QB		•	•
ASD-LSF8HV			•
ASD-LSF8-EM			•
ASD-LSF8-QB-EM		•	•

For most up-to-date spec sheets please refer to asd-lighting.com

ASD LIGHTING CORP

E-mail: orders@asd-lighting.com | Web site: www.asd-lighting.com





LED STRIPLIGHT FIXTURE

LSF8 series

MOTION SENSOR INFORMATION

REMOTE CONTROL **ASD-06RC** sold separately

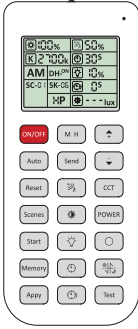

Button	Remarks	Button	Remarks	Button	Remarks
ON/OFF ON/OFF	Turn the sensor ON/OFF.	M H Mounting height	Adjust detection area/sensitivity levels according to real installation situations, higher or lower.	Up	The main functional buttons to adjust the factors to desired level.
Auto Auto	Enter "sensor mode" and perform previous settings.	Send Send	Memorize and send out the previous setting of individual parameters.	Down	Press + - button to dim light directly auto in non-detection mode.
Reset Reset	Enter "sensor mode" and perform the default settings.	Detection range	Also known as "sensitivity", 100 % means the highest sensitivity and longest distance. Use this button and the + - buttons to adjust.	CCT CCT selectable	Not applicable to this product.
Scenes Scenes	Shows current settings saved in remote.	Daylight sensor	The preset lux level at which motion will be detected. Use this button and the + - buttons to adjust.	POWER Power	Adjust brightness in both ON/OFF mode & sensor mode, minimum 10%, max 100%, each time this button is pressed it changes by 5%.
Start Start	Press this to begin scene setup.	Stand-by dimming	After hold time, the light will dim from 100 % to optional standby dimming levels. Use this button and the + - buttons to adjust.	Reserved button	Not applicable to this product.
Memory Memory	Saves the scene settings.	Hold time	The period that light will stay illuminated 100 % after no motion is detected. Use this button and the + - buttons to adjust.	Daylight harvesting	Daylight harvesting function enabled or disabled.
Apply Apply	Applies current scene settings to the fixture.	Stand-by period	The period after holdtime, during which the light keeps standby dimming level. Use this button and the + - buttons to adjust.	Test Test button	Press this button to test the sensor; it will temporarily change the hold time to 2s. This setting cannot be saved.



ASD-M22IR
Infrared motion sensor



ASD-06RC
Remote control

Specifications	Default setting
Detection area	100 %
Hold time	10 min
Daylight threshold	Disable
Standby period	0 s
Standby dimming level	10 %

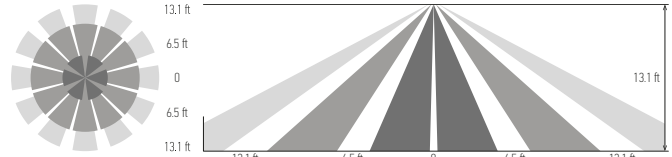

Mounting height < 13 ft (4 m) ceiling mounting

User notes:

1. The driver voltage shall be stable and float within 10%.
2. Detection area options may not function as expected because they depend on the Fresnel lens, which physically determines their operation.
3. Detection distance performance works better when moving parallel to the sensor as opposed to towards it.
4. Conduct testing with adequate ambient lighting for best results.
5. Dimming performance differs when connected to different drivers; If the driver can't completely turn OFF, sensor can't either.
6. The first time powering ON the sensor, light will be ON 100% for about 45s then dims to standby level or OFF.

Installation precautions:

1. PIR sensor can't be placed inside any material, fresnel lens must be completely exposed in air.
2. Fresnel lens of the PIR sensor must be lower than light fixture.
3. Suitable for ceiling mount installation, adjust sensitivity properly if it's installed on a wall because it will become more sensitive.

Application environment:

1. Suitable for indoor application, partial/completely outdoor environment conditions might trigger the sensor.
2. The PIR sensor is not suitable for environments with sudden changes in temperature or airflow.
3. Not suitable environment if there's shelves between the sensor and target area.
4. Shall be mounted securely, to avoid any false triggers caused by movement of the fixture itself.

Specifications	model: ASD-M22IR
Detection area	25 %/50 %/75 %/100 %
Hold time	5 s/30 s/1 min/3 min/5 min/10 min/20 min/30 min
Daylight threshold	2 lux (0.2 fc)/10 lux (0.9 fc)/30 lux (2.8 fc)/50 lux (4.7 fc)/80 lux (7.4 fc)/120 lux (11.2 fc)/200 lux (18.6 fc)/250 lux (23.2 fc)/300 lux (27.9 fc)/350 lux (32.5 fc)/400 lux (37.2 fc)/disable (for ASD-M22IR-NLS this value can be changed up to 2000 lux when controlled via the APP)
Standby period	0 s/10 s/30 s/1 min/5 min/10 min/30 min/60 min/+ ∞
Standby dimming level	10 %/20 %/30 %/50 %
Operating voltage	10 ~15 V
Operating current	< 10 mA
Mounting height	max 13 ft (4 m)
Detection range	6 - 13 ft (2-4 m)

For most up-to-date spec sheets please refer to asd-lighting.com

ASD LIGHTING CORP

E-mail: orders@asd-lighting.com | Web site: www.asd-lighting.com





LED STRIPLIGHT FIXTURE

LSF8 series

WITH DUSK/DAWN FUNCTION:

1. If ambient brightness is low, the sensor will turn on the light and maintain it at the standby dimming level, even without motion or presence.
2. When motion or presence is detected, the light will increase to 100%.
3. After motion is no longer detected, fixture remains at 100 % for hold time.
4. After the hold time expires, the light will dim back to the standby level and remain there.
5. If ambient brightness is sufficient, the sensor will automatically turn the light off.

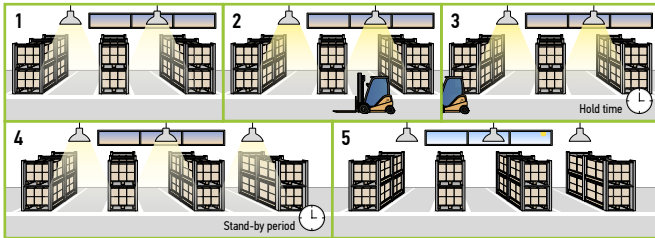

WITH DAYLIGHT THRESHOLD:

1. With sufficient daylight, the light remains OFF even when motion is detected.
2. With insufficient daylight, the sensor turns light ON when motion is detected.
3. Once motion is no longer detected, the light stays at 100% brightness for the designated hold time.
4. After the hold time expires, the sensor dims the light to the standby level for the preset standby period. If the standby period is set to 0s, the light turns OFF after the hold time.
5. Once the standby period ends, the sensor automatically turns the light OFF if no motion is detected.

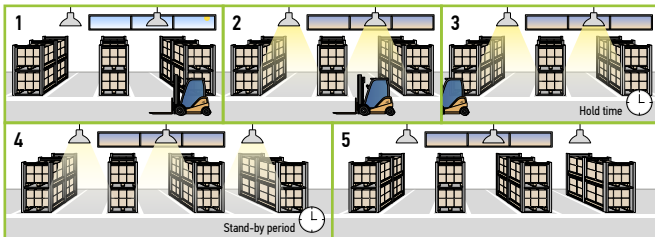

WITH DAYLIGHT DISABLED:

1. Sensor turns ON light when motion is detected.
2. Light will stay on after detecting motion for the desired hold time.
3. Sensor dims light to standby dimming level after hold time if there is still no motion.
4. Sensor turns OFF light after standby period.

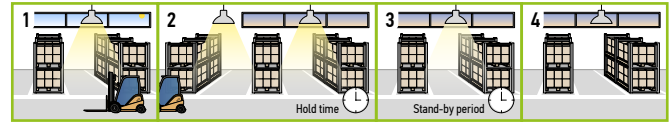

DAYLIGHT HARVESTING:

1. When ambient brightness falls below the preset lux level, the sensor will automatically turn on the light and adjust its brightness based on changes in ambient light. As it gets darker, the fixtures brighten, and as it gets brighter, the fixtures will dim accordingly.
2. When the ambient brightness exceeds the preset lux level, the light will turn OFF.

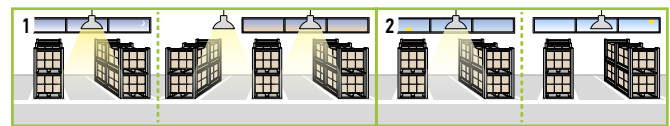

DAYLIGHT HARVESTING SETTING:



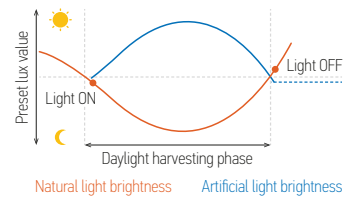

1. Ensure the fixture is in Sensor Mode.
2. Set the Standby Period to 0 seconds.
3. Set the daylight threshold to any of the following: 50 lux, 80 lux, 120 lux, 200 lux, 250 lux, 300 lux, 350 lux, or 400 lux.
4. Press the Daylight Harvesting button to activate.



BUILT-IN BATTERY BACK-UP INFORMATION

Specifications	for 2ft models	for 4ft models	for 8ft models
Input voltage	100-347 Vac 50/60 Hz	100-277 Vac 50/60 Hz	100-347 Vac 50/60 Hz
Voltage	30-56 V	25-48 V	90-260 V
Input current	≤ 100 mA	100 mA max	100 mA max
Output current	143-266 mA	200-400 mA	≤ 250 mA
Output power	8W	10W	15W
Lumen	1,374 lm	1,637 lm	2,467 lm
Emergency time	≥ 90 minutes		
Indicator light	Illuminated test switch, indicator light		
Battery	Li-ion battery 7.4 V/2500 mAh	Li-ion battery 11.1 V/2000 mAh	Li-ion battery 11.1 V/3000 mAh
Charging time	24 hours	≥ 24 hours	

STANDARD OPERATION DISPLAY STATUS:

Button for 2ft models	Button for 4-8ft models	Remarks
 ON	 ON	Charging mode, Battery is fully charged, AC power is ON
 ON	 OFF	Emergency mode, Battery is discharging, AC power is OFF

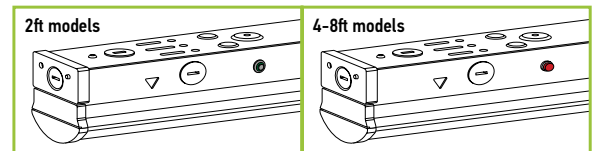

For most up-to-date spec sheets please refer to asd-lighting.com

ASD LIGHTING CORP

E-mail: orders@asd-lighting.com | Web site: www.asd-lighting.com





LED STRIPLIGHT FIXTURE

LSF8 series

INSTALLATION GUIDE

IMPORTANT SAFETY INFORMATION:

Please read all the instructions below before installation!

- ▶ Make sure that the supply voltage corresponds to the rated product voltage.
- ▶ The product must be installed by a qualified electrician in accordance with the National Electrical Code and corresponding local codes.
- ▶ If the product is damaged, do not use it.

⚠ WARNING

Risk of personal injury – read and follow all warnings and installation instructions. Keep or give to the owner for future reference.

Risk of cuts: Wear gloves to prevent cuts or abrasions when removing from carton, handling, installing, and maintaining this product.

Risk of electric shock: This product must be installed in accordance with the applicable installation code by a person familiar with the construction and operation of the product and the hazards involved.

Risk of Fire: Minimum 194°F supply conductors. Consult a qualified electrician to ensure correct branch circuit conductor.

ASD® assumes no responsibility for claims arising out of improper or careless installation or handling of this product.

CONNECTING MULTIPLE FIXTURES:

ASD-CB-LSF8 sold separately

1. Use a screwdriver to remove the screws from the adjacent end covers of the fixture bodies that need to be connected.
2. Mount the second fixture on the wall next to the first one, ensuring the two knockout holes in the center docking position are aligned and exposed.
3. Use the center connection bracket to join the fixtures and secure it in place with screws.

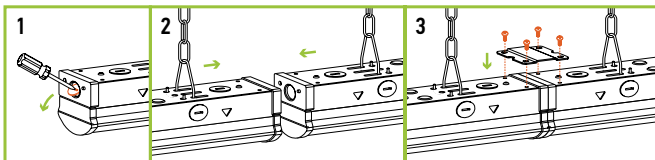

SURFACE MOUNT INSTALLATION:

1. Secure the baffle onto the back of the fixture with screws.
2. Open the fixture by pressing the area between the narrow rectangular hole and snap-lock. Secure the luminaire to the ceiling with plastic anchors and screws (not included). Connect the wires: Black to Black, White to White, Green to Green.
3. Reattach the lens to the fixture. Choose preferred color temperature and power by adjusting switch positions on the side of the fixture.

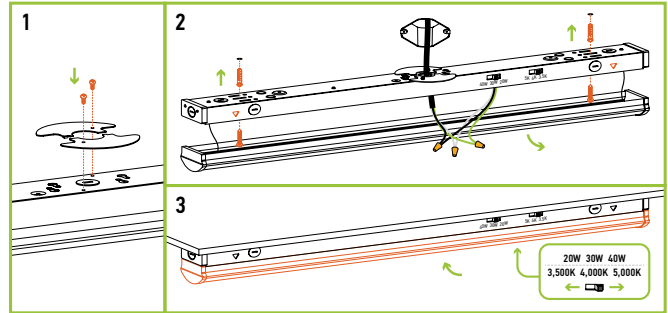

CHAIN MOUNT INSTALLATION:

1. Attach the V-hooks to the back of the fixture body, then insert a chain onto each hook. Secure the chains to the ceiling and adjust them until the fixture is balanced and stable.
2. Attach the end of metal hose to the outlet hole. Open the fixture body and connect the wires: Black to Black, White to White, Green to Green.
3. Close the fixture body to complete the installation. Adjust the switches on the side of the fixture to select your preferred color temperature and wattage.

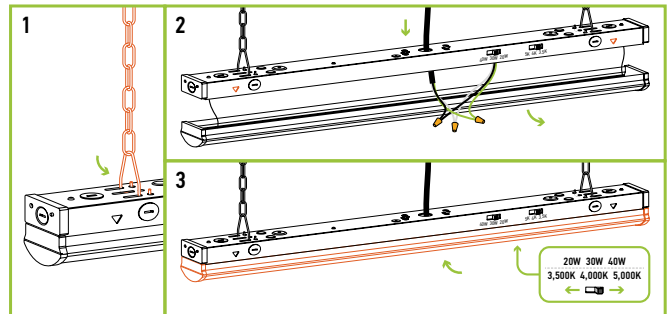

For most up-to-date spec sheets please refer to asd-lighting.com

ASD LIGHTING CORP

E-mail: orders@asd-lighting.com | Web site: www.asd-lighting.com





LED STRIPLIGHT FIXTURE

LSF8 series

ORDERING INFORMATION

Model	Product dimensions	Weight	Pcs. per carton	Carton size	Carton weight	UPC	GTIN 14
LSF8							
ASD-LSF8-2A25WH	24" x 2-11/16" x 3-1/8"	1.8 lbs (0.8 kg)	9	25.2" x 10" x 11.5"	20.1 lbs	810128119276	10810128119273
ASD-LSF8-4A40WH	47-1/4" x 2-11/16" x 3-1/8"	2.9 lbs (1.3 kg)	9	49" x 10" x 11.4"	33.2 lbs	810128118583	10810128118580
ASD-LSF8-4A40BK	47-1/4" x 2-11/16" x 3-1/8"		9	49" x 10" x 11.4"	33.2 lbs	810128118620	10810128118627
ASD-LSF8-4A70WH	47-1/4" x 2-11/16" x 3-3/16"	2.9 lbs (1.3 kg)	9	48.4" x 10" x 11.5"	33.2 lbs	810190200469	10810190200466
ASD-LSF8-8A80WH	94-1/2" x 2-11/16" x 3-1/8"	5.5 lbs (2.5 kg)	6	96.3" x 10" x 7.9"	41.9 lbs	810128118606	20810128118600
ASD-LSF8-8A80BK	94-1/2" x 2-11/16" x 3-1/8"		6	96.3" x 10" x 7.9"	41.9 lbs	810128118644	20810128118648
ASD-LSF8-8A150WH	94-1/2" x 2-11/16" x 3-3/16"	5.5 lbs (2.5 kg)	6	95.7" x 10" x 7.9"	41.9 lbs	810190200476	10810190200473
LSF8 WITH Q-BASE							
ASD-LSF8-2A25WH-QB	24" x 2-11/16" x 3-1/4"	1.8 lbs (0.8 kg)	9	25.2" x 10" x 11.5"	19.8 lbs	810128119245	10810128119242
ASD-LSF8-4A40WH-QB	47-1/4" x 2-11/16" x 3-1/4"	2.9 lbs (1.3 kg)	9	49" x 10" x 11.4"	33.1 lbs	810128119252	10810128119259
ASD-LSF8-8A80WH-QB	94-1/2" x 2-11/16" x 3-1/4"	5.3 lbs (2.4 kg)	6	96.3" x 10" x 11.4"	41.9 lbs	810128119269	10810128119266
LSF8 200-480V							
ASD-LSF8HV-4A40WH	47-1/4" x 2-11/16" x 3-3/16"	3.9 lbs (1.8 kg)	9	48.4" x 10" x 11.5"	42.1 lbs	81012811945	10810128119457
ASD-LSF8HV-8A80WH	94-1/2" x 2-11/16" x 3-3/16"	6.3 lbs (2.9 kg)	6	95.7" x 10" x 7.9"	46.9 lbs	81012811946	10810128119464
LSF8 WITH BATTERY BACK-UP							
ASD-LSF8-2A25WH-8EM	24" x 2-11/16" x 3-1/8"	2.4 lbs (1.1 kg)	9	25.2" x 10" x 11.5"	25.3 lbs	810128119283	10810128119280
ASD-LSF8-4A40WH-10EM	47-1/4" x 2-11/16" x 3-1/8"	3.5 lbs (1.6 kg)	9	49" x 10" x 11.4"	38.4 lbs	810128118590	10810128118597
ASD-LSF8-4A40BK-10EM	47-1/4" x 2-11/16" x 3-1/8"		9	49" x 10" x 11.4"	38.4 lbs	810128118637	10810128118634
ASD-LSF8-8A80WH-15EM	94-1/2" x 2-11/16" x 3-1/8"	6 lbs (2.7 kg)	6	96.3" x 10" x 7.9"	45.5 lbs	810128118613	20810128118617
ASD-LSF8-8A80BK-15EM	94-1/2" x 2-11/16" x 3-1/8"		6	96.3" x 10" x 7.9"	45.5 lbs	810128118651	20810128118655
LSF8 WITH Q-BASE AND BATTERY BACK-UP							
ASD-LSF8-2A25WH-QB-8EM	24" x 2-11/16" x 3-1/4"	2.6 lbs (1.2 kg)	9	25.2" x 10" x 11.5"	26.9 lbs	810128119290	10810128119297
ASD-LSF8-4A40WH-QB-10EM	47-1/4" x 2-11/16" x 3-1/4"	3.9 lbs (1.8 kg)	9	49" x 10" x 11.4"	42 lbs	810128119306	10810128119303
ASD-LSF8-8A80WH-QB-15EM	94-1/2" x 2-11/16" x 3-1/4"	6.5 lbs (3 kg)	6	96.3" x 10" x 11.4"	48.2 lbs	810128119313	10810128119310

ACCESSORIES:

Model	Product dimensions	Pcs. in middle box	Middle box size	Middle box weight	Pcs. per carton	Carton size	Carton weight	UPC	GTIN 14 in middle box	GTIN 14 in carton
ASD-09MW-WH	2-1/8" x 2-1/8" x 1-5/16"	10	10.2" x 2.8" x 1.6"	0.4 lbs	200	11.8" x 11" x 8.9"	11.4 lbs	810128119238	10810128119235	20810128119232
ASD-06RC	5-11/16" x 1-3/4" x 13/16"	10	6.3" x 2.9" x 1.14"	0.5 lbs	60	15.8" x 11.8" x 9.3"	24.7 lbs	810128114370	30810128114371	40810128114378
ASD-CB-LSF8-WH	2-3/16" x 2-3/16" x 1/16"	-	-	-	100	7.5" x 5.1" x 5.5"	4.6 lbs	810128119689	-	10810128119686
ASD-CB-LSF8-BK	2-3/16" x 2-3/16" x 1/16"	-	-	-	100	7.5" x 5.1" x 5.5"	4.6 lbs	810128119696	-	10810128119693

For most up-to-date spec sheets please refer to asd-lighting.com

ASD LIGHTING CORP

E-mail: orders@asd-lighting.com | Web site: www.asd-lighting.com





LED STRIPLIGHT FIXTURE

LSF8 series

ANNEX 1

Model	Watts	3,500 K	4,000 K	5,000 K
ASD-LSF8-2A25WH	15W	2,028 lm	2,069 lm	2,021 lm
	20W	2,663 lm	2,753 lm	2,686 lm
	25W	3,239 lm	3,377 lm	3,249 lm
ASD-LSF8-4A40WH ASD-LSF8-4A40BK	20W	3,061 lm	3,104 lm	3,112 lm
	30W	4,439 lm	4,560 lm	4,569 lm
	40W	5,733 lm	5,926 lm	5,866 lm
ASD-LSF8-4A70WH	50W	7,248 lm	7,508 lm	7,332 lm
	60W	8,668 lm	9,086 lm	8,781 lm
	70W	9,054 lm	9,883 lm	9,124 lm
ASD-LSF8-8A80WH ASD-LSF8-8A80BK	55W	8,433 lm	8,564 lm	8,560 lm
	75W	10,886 lm	11,365 lm	11,124 lm
	80W	11,591 lm	12,224 lm	11,848 lm
ASD-LSF8-8A150WH	100W	14,698 lm	15,392 lm	15,429 lm
	130W	18,160 lm	19,238 lm	19,188 lm
	150W	19,466 lm	21,427 lm	20,263 lm
ASD-LSF8-2A25WH-QB	15W	2,011 lm	2,064 lm	2,028 lm
	20W	2,646 lm	2,754 lm	2,697 lm
	25W	3,206 lm	3,378 lm	3,263 lm
ASD-LSF8-4A40WH-QB	20W	2,921 lm	2,976 lm	2,960 lm
	30W	4,108 lm	4,248 lm	4,213 lm
	40W	5,283 lm	5,522 lm	5,395 lm
ASD-LSF8-8A80WH-QB	55W	8,194 lm	8,419 lm	8,280 lm
	75W	10,575 lm	11,016 lm	10,718 lm
	80W	11,247 lm	11,782 lm	11,386 lm
ASD-LSF8HV-4A40WH	20W	3,061 lm	3,104 lm	3,112 lm
	30W	4,439 lm	4,560 lm	4,569 lm
	40W	5,733 lm	5,926 lm	5,866 lm
ASD-LSF8HV-8A80WH	55W	8,433 lm	8,564 lm	8,560 lm
	75W	10,886 lm	11,365 lm	11,124 lm
	80W	11,591 lm	12,224 lm	11,848 lm
ASD-LSF8-2A25WH-8EM	15W	2,028 lm	2,069 lm	2,021 lm
	20W	2,663 lm	2,753 lm	2,686 lm
	25W	3,239 lm	3,377 lm	3,249 lm
ASD-LSF8HV-4A40WH-10EM ASD-LSF8HV-4A40BK-10EM	20W	3,061 lm	3,104 lm	3,112 lm
	30W	4,439 lm	4,560 lm	4,569 lm
	40W	5,733 lm	5,926 lm	5,866 lm
ASD-LSF8-8A80WH-15EM ASD-LSF8-8A80BK-15EM	55W	8,433 lm	8,564 lm	8,560 lm
	75W	10,886 lm	11,365 lm	11,124 lm
	80W	11,591 lm	12,224 lm	11,848 lm
ASD-LSF8-2A25WH-QB-8EM	15W	2,011 lm	2,064 lm	2,028 lm
	20W	2,646 lm	2,754 lm	2,697 lm
	25W	3,206 lm	3,378 lm	3,263 lm
ASD-LSF8-4A40WH-QB-10EM	20W	2,921 lm	2,976 lm	2,960 lm
	30W	4,108 lm	4,248 lm	4,213 lm
	40W	5,283 lm	5,522 lm	5,395 lm
ASD-LSF8-8A80WH-QB-15EM	55W	8,194 lm	8,419 lm	8,280 lm
	75W	10,575 lm	11,016 lm	10,718 lm
	80W	11,247 lm	11,782 lm	11,386 lm

For most up-to-date spec sheets please refer to asd-lighting.com

ASD LIGHTING CORP

E-mail: orders@asd-lighting.com | Web site: www.asd-lighting.com

